

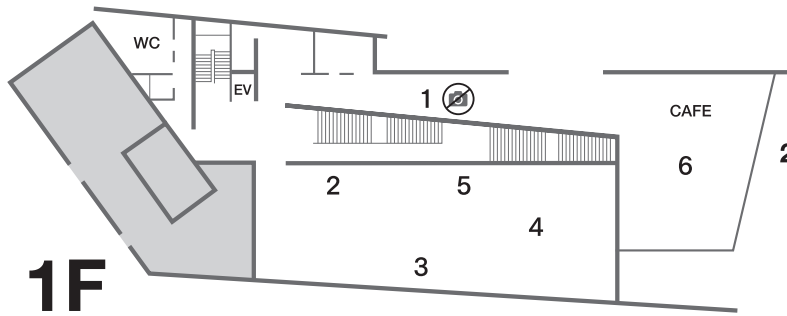

Inaugural Exhibition — From the Origin to the Future

This inaugural exhibition features representative works and freshly commissioned works by 12 artists and groups, including those who involved with Benesse Art Site Naoshima from its early years, as well as others who have developed a relationship since 2016 when the Benesse Prize moved from Venice to Asia, and also those encountered on research trips in recent years. The works are on view in multiple gallery spaces located on the first floor and two basement floors, as well as the cafeteria and outdoor sites. Through the sharp gazes and questions that art casts upon our times, society and the environment, we are encouraged to think about and reaffirm what is “Well-Being” —the idea rooted in the origin of Benesse’s activities that began in Naoshima.



1 Shitamichi Motoyuki + Jeffrey Lim

 **Setouchi “Roaming Family” Photo Studio**
(From the project “Setouchi” “Archive”)
2024

A satellite exhibition of the project series titled “Setouchi “Archive” conducted by Shitamichi Motoyuki since 2019 in Miyanoura, Naoshima. The project creates an archive space through research, collection, and an exhibition related to the local landscape, culture, folk customs, and history of the Setouchi region. In 2024, Shitamichi Motoyuki focused on “the fluidity of the people coming into and going out of Naoshima” and organized an exhibition, “Setouchi “Roaming Family” Photo Studio.” On view in this exhibition here are the islanders’ family photographs he and Malaysian cultural activist Jeffrey Lim took in the landscape of Naoshima with box cameras handmade from driftage washed ashore to the Naoshima islands, as well as photographs of Naoshima residents taken during the exhibition period at the photo studio.

3 Heri Dono

The Odyssey of Heridonology
2014

Angels Fallen from the Sky
2004

The ten-piece set of paintings entitled *The Odyssey of Heridonology* is a monumental work that reflects Heri Dono’s entire decades-long career, as well as the modern and contemporary history of Indonesia behind it, with elements of the artist’s past works of sculpture, installation and performance incorporated in the natural landscape with the ocean, mountains and forests. Through his own expression that features acute political and social satire, the work suggests how nature is important for human beings and the future. *Angels Fallen from the Sky*, a ceiling-suspended installation featuring angelic figures carrying torpedoes, stems from the artist’s imagination and draws inspiration from the American comic *Flash Gordon*. The installation communicates the importance of freedom to dream and imagine in order to build the future, referring to the times in Indonesia when freedom of speech was repressed.

6 N. S. Harsha

Happy Married Life
2025

Through these celebratory and colourful paintings, N. S. Harsha proposes a cafe area as a ‘wedding hall’ in which two visions of human life, ‘Introspection and Extrospection,’ are being married. Three walls of the cafe are conceived as “wedding,” “cooking,” and “eating” areas. In the wedding wall, the central panel celebrates the bride (microscope) and the groom (telescope). The second wall panels celebrate the preparations of the food. And on the third wall, humans reveal their identity by taking off their parakeet masks, and consume food in different styles. Due to its mimetic talent, parakeets metaphorically suggest the fact that human beings have imitated nature and acquired immense understanding from nature.

2 Martha Atienza

Tigpanalipod (The Protectors)
11° 02’ 06.4” N 123° 36’ 24.1” E (2)
2022

Tigpanalipod, meaning The Protectors, is a word that persistently comes to mind in Martha Atienza’s work with communities across the Bantayan group of islands, north of Cebu in the Philippines. Since 2010, Atienza has been collaborating with fisherfolk on the island, confronting recurring questions: Who owns the land? Who owns the sea? Under the guise of promised economic prosperity, Bantayan Island has been shaped by the interests of the tourism industry, landed elites, and government. Since 2013, more than 9,000 fisherfolk and their families have been displaced—relocated to government housing projects, removed from the coastal areas they have long called home. Considering memory as a way to challenge a system designed to suppress and erase, Atienza invites the viewer to take part in the act of remembering. Her practice is deeply rooted in community, and through GOODLand—a site-specific, socially engaged art platform—she runs interconnected programs grounded in care for land, water, culture, and community, with a core focus on local knowledge.

4 Heri Dono & indieguerillas

Consciousness of Humanity: a Journey to the Center
2024-2025

This collaborative artwork by Heri Dono and indieguerillas emphasizes how art can connect people with differing views to foster harmony. Combining motifs from Javanese traditional leather puppet theater and cartoons, the work invites reflection on the beauty of diversity and human flourishing. The seven pieces depict everyday activities and convey messages about respect for nature, symbiosis, and collaboration.

5 Pannaphan Yodmanee

Aftermath
2016/2025

This work, which received the 11th Benesse Prize, is an installation with huge murals and sculptures that explores the meanings of change, development, evolution, and destruction in the relationship between Buddhist cosmology, modern science and everyday life. The work poses questions to the present age about universal themes for human beings, such as time, loss, and devastation, as well as the sense of impending end, through the rich imagination of the artist with traditional Thai Buddhist art and design.

Around the outdoor approach

Meditation workshops and temporary pavilion for
***The Sound of Naoshima* by Sanitas Pradittasnee,**
scheduled to be completed in 2026

Admiring the “88 temples of Naoshima” scattered across the island, Sanitas Pradittasnee creates an open-air installation of stupas that leads us to meditation combining traditional Thai technique and materials found in Naoshima, which she conceived in the state of mindfulness only attained through the experience of “listening to the sound of one hand clapping by the ear in mind” derived from a Zen question. Prior to the completion of the work 2026, meditation workshops are planned at a temporarily and occasionally installed pavilion resembling a stupa composed of 108 bronze leaves.

*For the schedule of the workshops, please visit our homepage.

7 Do Ho Suh

Hub/s, Naoshima, Seoul, New York, Horsham, London, Berlin
2025

Hub, 759 Naoshima-cho, Kagawa-gun, Kagawa, Japan, 2025
Hub, 260-10 Sungbook-dong, Sungbook-ku, Seoul, Korea, 2016
Hub-1, 455 W 23rd St, Apt 15C London Terrace, New York, NY 10011, United States, 2020
Hub-1, Kitchen Lobby, 185 Comptons Lane, Horsham, United Kingdom, 2020
Hub, 3rd Floor, Union Wharf, 23 Wenlock Road, London N1 7ST, UK, 2016
Wielandstr. 18, 12159 Berlin - Corridors 1 & 2, 2011
Hub-2, Breakfast Corner, 260-7, Sungbook-Dong, Sungbook-Ku, Seoul, Korea, 2018
Hub-1, Entrance, 260-7, Sungbook-Dong, Sungbook-Ku, Seoul, Korea, 2018

Do Ho Suh's "Hub" series recreates, in translucent fabric, entrances and transitional spaces from the homes and studios he has occupied around the world. This exhibition of an eight-part "Hub" series includes spaces from the cities of Seoul, New York, London, Horsham, and Berlin. The installation additionally includes the hallway of a house in Naoshima that Suh visited during a research trip around the island. While most of the "Hub" relate to Suh's personal experience and autobiography, viewers are invited to 'activate' the structure by moving through it, perhaps reflecting on their own memories, and the experience of Naoshima as a site enabling people from Japan and overseas to meet and cross over.

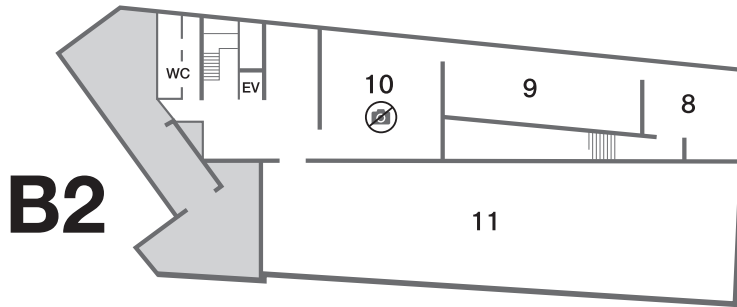
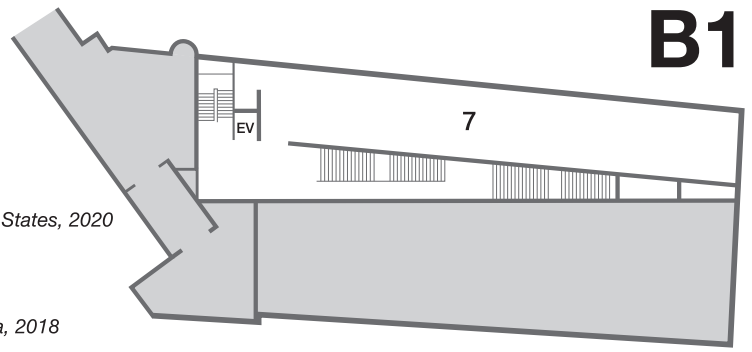

8 Chim ↑ Pom from Smappa!Group

The Sweet BOX: MICHI in Transit
2024-

Drawing Mirai: in Transit
2016-

Chim ↑ Pom from Smappa!Group, Takashi Suo

MICHI: blueprint
2025

Chim ↑ Pom from Smappa!Group has built *MICHI* [street] in the Kitakore Building in Koenji, Tokyo, as part of their "Sukurappu ando Birudo Project" (2016-). In this exhibition, they show *MICHI* "in transit" in preparation for its relocation in anticipation of the building's demolition, which eventually will take place, and the museum serves as a site for the process of the project. Asphalt, which is not usually subject to relocation, and construction debris used as roadbed material; ranging from the bustling postwar period, the period of rapid economic growth symbolized by the Tokyo 1964 Olympic Games, to the bubble period when the PARCO (a leading fashion company) culture flourished, compose layers of the times and are stored in the shipping container like a time capsule. Along with works including the blueprint of the relocation plan, the exhibition suggests the possibilities of "building" the future with our own hands from "scraps" of things "made and destroyed" in the past.

10 Aida Makoto

 **MONUMENT FOR NOTHING – Red TORII Gate**
2025

The latest work of the series titled "MONUMENT FOR NOTHING," which Aida Makoto has continued since 2008 in various ways. Themed on "How Japan has been/is being transformed," the artist has created the huge sculptural monument as if tracing the memories of an enormous number of images provided by various media in Japan in the past, mainly during the three decades since 1990 until today. Viewers are reminded of the events of their individual past like flashbacks. As Aida remarked, "a hope for any form of rebirth" is projected onto the work resembling an apparatus to resist oblivion and keep remembering.

9 Takashi Murakami

Rakuchū-Rakugai-zu Byōbu: Iwasa Matabei RIP
2023-2025

A monumental work with a width of 13 meters created after Iwasa Matabei's *Scenes In and Around Kyoto (Funaki version)* (17th century, national treasure), a pair of folding screens that depicted the aerial view of famous sites and everyday life in early modern Kyoto. After its debut in a solo exhibition in Kyoto in 2024, the painting was further refined. Depicted on the screens that meticulously portray lively scenes are approximately 2,700 people and characters created by Takashi Murakami, such as Mr. DOB, Kaikai and Kiki, among others, strutting around Kyoto. The prosperous cityscape of Kyoto is filled with golden clouds of numerous skulls, which evoke the wars, turmoil, and various disasters that lay behind the hustle and bustle of the capital. The work communicates a universal message relevant even today, that life and death, and light and darkness, exist side by side.

11 Cai Guo-Qiang

Head On
2006

Vortex
2006

Illusion II
2006

Originally created for his solo exhibition at the Deutsche Guggenheim in Berlin, *Head On* is a large-scale installation by artist Cai Guo-Qiang featuring 99 lifelike wolves charging forward with fierce determination, colliding headlong into a glass wall without hesitation. The wall, which is the same height as the Berlin Wall was, symbolizes the intangible yet deeply felt ideological and cultural divisions between people and communities. The work reflects on the human condition: our dangerous loyalty to dominant ideologies and our seemingly fated cycle of error. The gunpowder painting *Vortex*, created alongside the installation, explores the complex and ambiguous relationship between destruction and creation. The wolves spiral in a circular motion, as if irresistibly drawn into a swirling vortex, their movements charged with energy and determination. The video work *Illusion II* documents an explosion project near the former site of Berlin's Anhalter Station. The artwork contemplates the dual nature of violence and beauty, evoking both the grandeur and the devastation that mark the layered history of this ground.



Please do not take photos in areas marked with the no photography sign.



Please do not take photos in a way that disturbs others.



Please do not use flash.



Please do not use tripods or selfie sticks.



No video recording is allowed.



Please do not touch the artworks, walls or glass.



Eating, drinking, and smoking are not allowed.

